

SS-MD333

SERVICE MANUAL



*US Model
Canadian Model
AEP Model
UK Model
E Model
Australian Model
Tourist Model*

- This set is the speaker system in DHC-MD333.

SPECIFICATIONS

| | |
|----------------|---|
| Speaker system | 2way, bass-reflex type |
| Speaker units | Woofer : 13 cm dia., cone type Tweeter : 2.5 cm dia., balanced drive |
| Dimensions | Approx. 170 × 275 × 240 mm (6 ³ / ₄ × 10 ⁷ / ₈ × 9 ¹ / ₂ in) (w / h / d) incl. projecting parts and controls |
| Mass | Approx. 3.0 Kg (6 lb 10 oz.) net per speaker |

Design and specifications are subject to change without notice.

SPEAKER SYSTEM

SONY®



EXPLODED VIEW AND PARTS LIST

NOTE:

- Items marked by asterisk ("*") are not stocked since they are seldom required for routine service. Some delay should be anticipated when ordering these items.

- Abbreviation
- G : German
- AED : North European

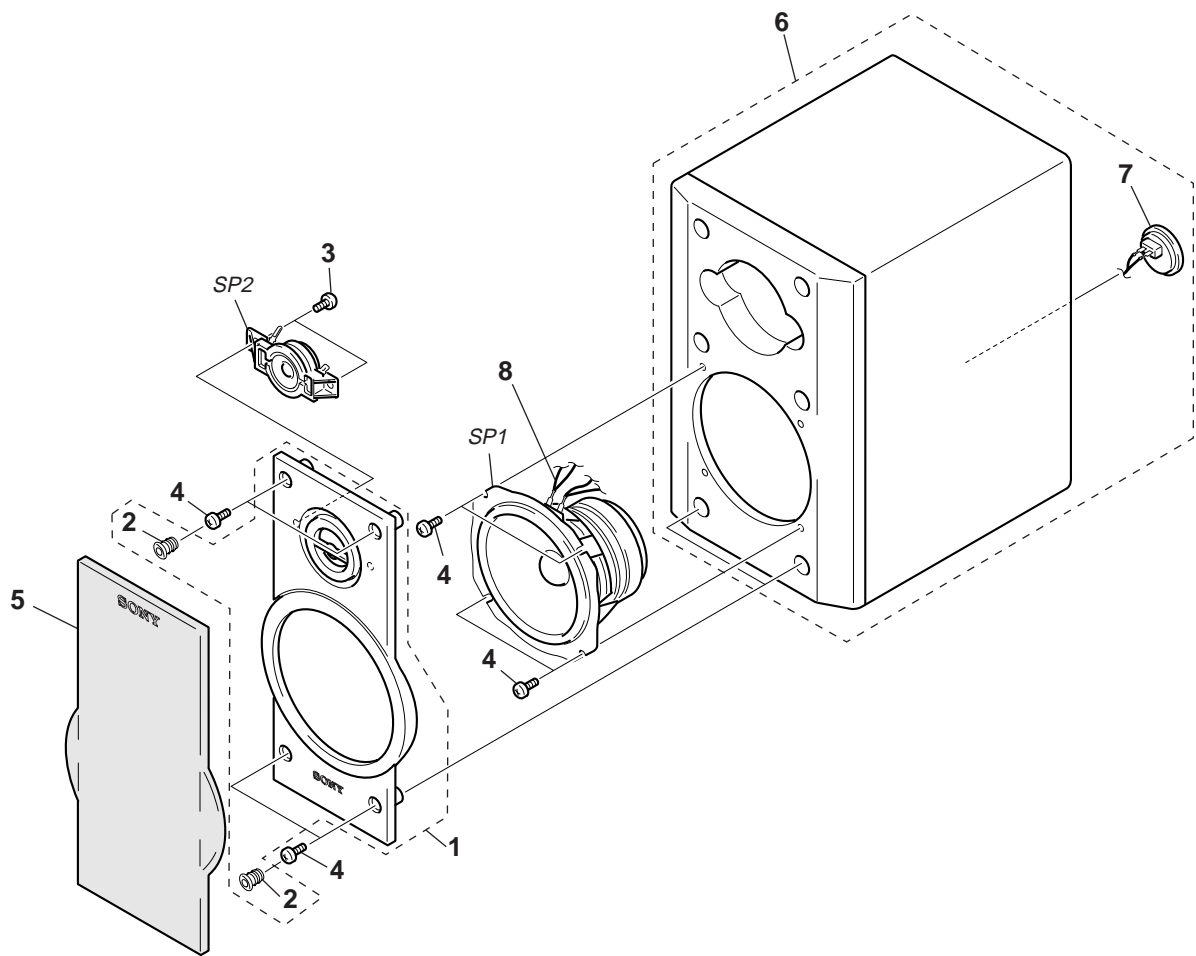

| Ref. No. | Part No. | Description | Remarks | Ref. No. | Part No. | Description | Remarks |
|----------|--------------|---------------------------------------|---------|---------------------------------|--------------|------------------|---------|
| 1 | X-4950-311-1 | PANEL ASSY, FRONT | | 8 | 1-790-101-11 | CORD | |
| 2 | 4-963-075-01 | CATCHER | | SP1 | 1-505-773-11 | SPEAKER (12 cm) | |
| 3 | 3-703-840-01 | SCREW, TAPPING | | SP2 | 1-505-727-21 | SPEAKER (2.5 cm) | |
| 4 | 4-874-614-21 | SCREW (4) (3.5 × 14), TAPPING | | ACCESSORIES & PACKING MATERIALS | | | |
| 5 | X-4950-312-1 | FRAME ASSY, GRILLE | | ***** | | | |
| 6 | A-4411-255-A | CABINET ASSY, SPEAKER (EXCEPT G, AED) | | 1-782-794-11 CORD, SPEAKER | | | |
| * 6 | A-4411-255-B | CABINET ASSY, SPEAKER (G, AED) | | | | | |
| 7 | 1-694-345-11 | TERMINAL BOARD | | | | | |